

THE DESIGN AND DETAILS DISCLOSED HEREIN ARE THE EXCLUSIVE PROPERTY OF CARLIN MANUFACTURING INC. AND SHALL NOT BE COPIED OR REPRODUCED IN WHOLE OR IN PART WITHOUT THE PRIOR WRITTEN CONSENT OF CARLIN MANUFACTURING INC. ©2004 CARLIN MANUFACTURING LLC.

REVISIONS				
ZONE	REV	DESCRIPTION	DATE	APPROVED

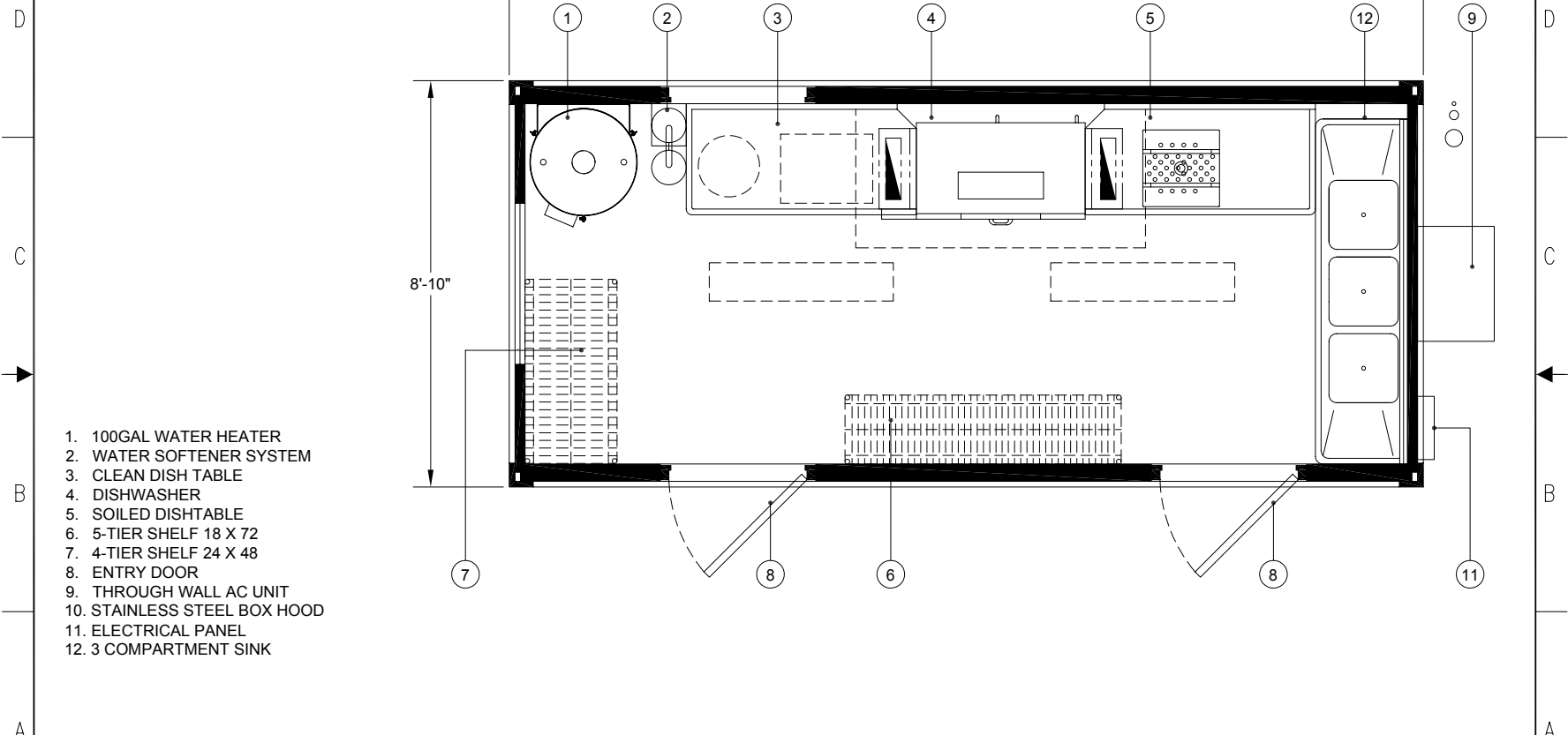

- 1. 100GAL WATER HEATER
- 2. WATER SOFTENER SYSTEM
- 3. CLEAN DISH TABLE
- 4. DISHWASHER
- 5. SOILED DISHTABLE
- 6. 5-TIER SHELF 18 X 72
- 7. 4-TIER SHELF 24 X 48
- 8. ENTRY DOOR
- 9. THROUGH WALL AC UNIT
- 10. STAINLESS STEEL BOX HOOD
- 11. ELECTRICAL PANEL
- 12. 3 COMPARTMENT SINK

<b>Kitchens To Go</b>		UNLESS OTHERWISE SPECIFIED DIMENSIONS ARE IN INCHES TOLERANCES ARE:	
CAPITAL CAMP - MODULE 3 MODULAR KITCHEN UNIT		FRACTIONS	DECIMALS
REV: B		FRAC 1/16	XXX+T .06
CASE CODE: 560A01-0-01_1		ANG 1/2°	XXX+T .002
SCALE: 1/2" = 1' = 0"		DO NOT SCALE DRAWINGS	
DRAWING PREPARED IN ACCORDANCE WITH HML-0306, HML-070-105, AND ANSI Y14.5		DRAWN TO:	

CC560		<b>CARLIN</b> MANUFACTURING LLC	
APPROVALS	DATE	FLOOR PLAN AND EQUIPMENT LIST	
DESIGN: GSF	5-10-04	REV: B	REV:
SCALE: 1/2" = 1' = 0"	CASE CODE: 560A01-0-01_1	DRAWING TO:	